



To Facilitate the Collaboration of All the Stakeholders in the STL Region's Built Environment in Creating Inclusive, Robust Employment and Economic Growth.

Home > Projects > Avenue Intros its Active Adult Living to St. Louis

Avenue Intros its Active Adult Living to St. Louis

Posted on 04/16/2024

A growing trend in active adult living is unfolding in St. Peters, Mo. with the construction of the \$37.8 million Viva Bene in St. Peters, Mo. Developed by Avenue, the 161-unit luxury living apartment community will be completed this fall by Midas Construction and will feature a number of amenities for age 55-plus active adults. According to San Francisco-based Grand View Research, the emerging active adult lifestyle market catering to those 55 and older was valued at \$587.7 billion in 2023 and is expected to grow at an annual compounded rate four percent from 2023 to 2030.



Located at 101 Viva Bene Circle in St. Peters, the four-story community features one- and two-bedroom rental apartments with a variety of floor plans.

Amenities include a resort-style pool, an advanced fitness center and spin studio, a wellness and fitness hub with a yoga and education center, co-working spaces, detached garages and outdoor gathering and recreational space including pickleball and bocce ball courts.

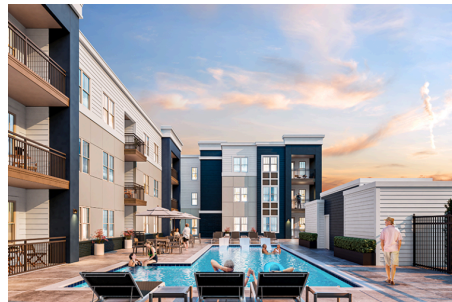

The well-appointed living spaces feature wood-look flooring, pendant lighting and stainless-steel appliances, spa-inspired bathrooms, in-unit washer and dryer, and apartment and community storage space.

Midas has overcome weather challenges in the early stages of construction to keep the project on schedule. Midas is utilizing Exacor, a magnesium oxide product that is used in lieu of gypcrete. It achieves the fire and sound barrier between the floors and more efficiently advances the overall schedule of the project.

Greystar is the property manager for Viva Bene. For more information on the apartments and leasing, contact Donna Griffin at 636-706-5000 or visit www.vivabenestpeters.com.

Indianapolis-based **Avenue** is a full-service real estate development and advisory group focused on innovative solutions for wellness-centered healthcare and senior living properties.

Midas Construction is a leading commercial construction company based in St. Louis, Mo. The firm specializes in high rise hotels, luxury multifamily, mixed use, and senior housing. Projects under construction for 2023 approached \$300 million in the St. Louis metro area thus fulfilling the mission "Building great communities in which we live and work." Notable projects include AC Hotel in the Central West End, The Prairie at Dardenne Prairie, Residence Inn in Clayton, the MILA apartments in Ellisville, and Element St. Louis Midtown.

SEARCH

Search here... 

SPONSORS



LATEST NEWS



Electrical Connection Donates Services For St. Jude Dream Home

An IBEW/NECA Electrical Connection team is now wiring the...
04/30/2024 0



ASA Midwest Council Celebrates Red Carpet Gala Nominees & Winners

The American Subcontractors Association (ASA) Midwest Council celebrated the...
04/30/2024 0



AGC Of Missouri Awards \$82,000 In Scholarships

The Associated General Contractors of Missouri (AGCMO) has awarded...
04/30/2024 0



Forum Drone Update: ARCO's NEO Vantage Pointe

This week Construction Forum drone photographer Louis Kelly, owner...
04/30/2024 0

RELATED POSTS



Electrical Connection
Donates Services For St. Jude Dream Home



ASA Midwest Council
Celebrates Red Carpet Gala Nominees & Winners



AGC Of Missouri Awards
\$82,000 In Scholarships



Forum Drone Update:
ARCO's NEO Vantage Point

LEAVE A REPLY

Your email address will not be published. Required fields are marked *

Comment *

Name *

Email *

Website

I'm not a robot reCAPTCHA
Privacy - Terms

Post Comment

Recent Tags

- [HOME PAGE](#) [COVID-19](#) [WORKFORCE](#)
- [INFRASTRUCTURE](#) [MODOT](#) [CLAYCO](#)
- [AGC](#) [NGA](#) [IBEW](#) [MCCARTHY](#) [HOK](#)
- [ELECTRICAL CONNECTION](#) [NECA](#)
- [CLAYTON](#) [SAFETY](#)
- [WASHINGTON UNIVERSITY](#) [DIVERSITY](#)
- [S.M. WILSON](#) [TARLTON](#)
- [LAWRENCE GROUP](#) [METROLINK](#)
- [EDWARDSVILLE](#) [CHESTERFIELD](#)
- [MENTAL HEALTH](#)

Select a Category

- [COVID-19 UPDATES](#) (684)
- [Discussion](#) (3,173)
- [Drone](#) (80)
- [Emerging Leaders Group](#) (5)
- [Environment/Sustainability](#) (204)
- [Forum Focus Podcast](#) (14)
- [Ideas](#) (2,698)
- [News](#) (5,826)
- [Organizations](#) (2,711)
- [People](#) (2,472)
- [Positions Wanted](#) (2)
- [Positions Wanted](#) (5)
- [Projects](#) (5,614)
- [Regionalism](#) (446)
- [White Papers](#) (119)
- [Workforce](#) (2,412)

Login

- [Log in](#)
- [Entries feed](#)
- [Comments feed](#)
- [WordPress.org](#)

Follow us



Copyright © 2013-2021 Constructforstl.org. Site maintained by Master Key Interactive.

Search here...



Translate »